

Leaning Tower of Pisa, Italy: Assembly Instructions

Canon ® is a registered trademark of Canon Inc. © Canon Inc. © Y.Watanabe



PAPER CRAFT

<http://www.canon.com/c-park/en/>



View of completed model

*This model was designed for Papercraft and may differ from the original in some respects.

Assembly Instructions: Three A4 sheets (No. 1 to No. 3)

*Build the model by carefully reading the Assembly Instructions, in the parts sheet page order.

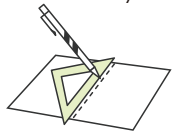

*Hint: Trace along the folds with a ruler and an exhausted pen (no ink) to get a sharper, easier fold.

Assembly Instructions



Mountain fold(dotted line)
Make a mountain fold.



Valley fold(dashed and dotted line)
Make a valley fold.



Scissors line(solid line)
Cut along the line.



Cut in line(solid line)
Cut along the line.

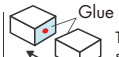

Glue
The glue spot(colored dot) shows where to apply the glue.



Glue spot(Red dot)
Glue parts with the same shape together.



Glue spot(Green dot)
Glue within the same part.



Glue spot(Blue dot)
Glue to the rear of the other part.

Tools and materials



Scissors, set square, glue(We recommend stick glue), pencil, used ballpoint pen, toothpicks, tweezers, (useful for handling small parts)

Assembly tip



Before gluing, crease the paper along mountain fold and valley fold lines and make sure rounded sections are nice and stiff.

Caution



Glue, scissors and other tools may be dangerous to young children so be sure to keep them out of the reach of young children.

Before starting assembly: Writing the number of each section on its back side before cutting out the sections is highly recommended. (* This way, you can be sure which section is which even after cutting out the sections.)

→ Indicates where sections should be glued together.

Glue the upper glue tabs of part 3 to the inside areas with circles on the printed side of part 4.

Reverse side of part 4

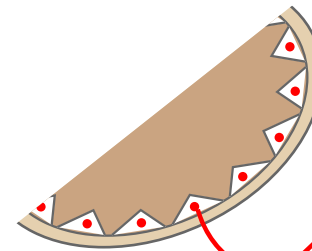

Printed side of part 4

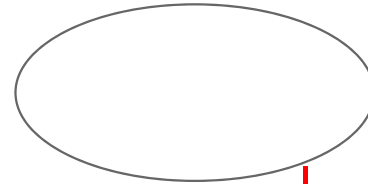

Carefully glue the lower glue tabs of part 3 to the glue areas of part 1, one at a time.

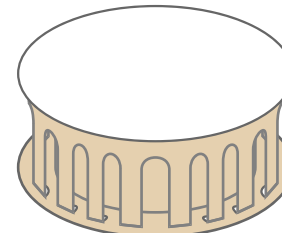
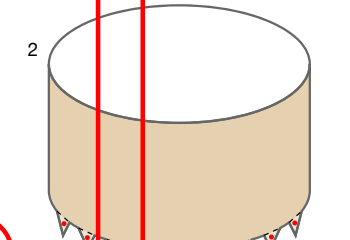
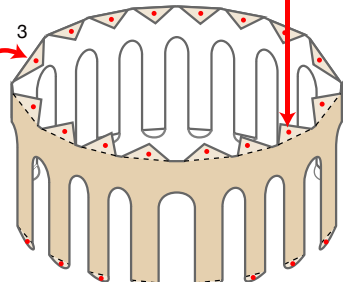

Use parts 1 - 4 to build six identical components.

Leaning Tower of Pisa, Italy: Assembly Instructions

Glue parts 8 + 9 to the glue tabs on the outside of parts 6 + 7.

Top of part 5

Side of parts 6 + 7

Glue part 5 to the glue tabs inside parts 6 + 7.

Glue part 5 and parts 6 + 7 together so that the narrower side of parts 6 + 7 faces in the same direction as the area of part 5 on which steps are printed.

Glue part 11 to part 10 along the circle on the inside of part 11.

Glue part 10 to parts 5 - 9 along the circle on the inside of part 5. When doing so, match the entrance printed on part 10 to the steps printed on part 5.

5+6+7+8+9

Make a cut along the red line from the edge and then cut out the center circle.

Glue part 15 in place after assembling the stand.

12

13

14

15

Leaning Tower of Pisa, Italy: Assembly Instructions

Canon ® is a registered trademark of Canon Inc. © Canon Inc. © Y.Watanabe

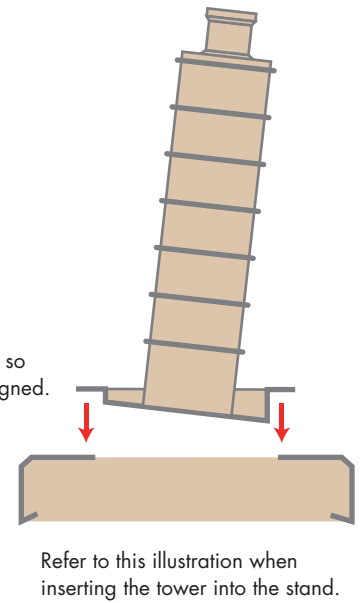
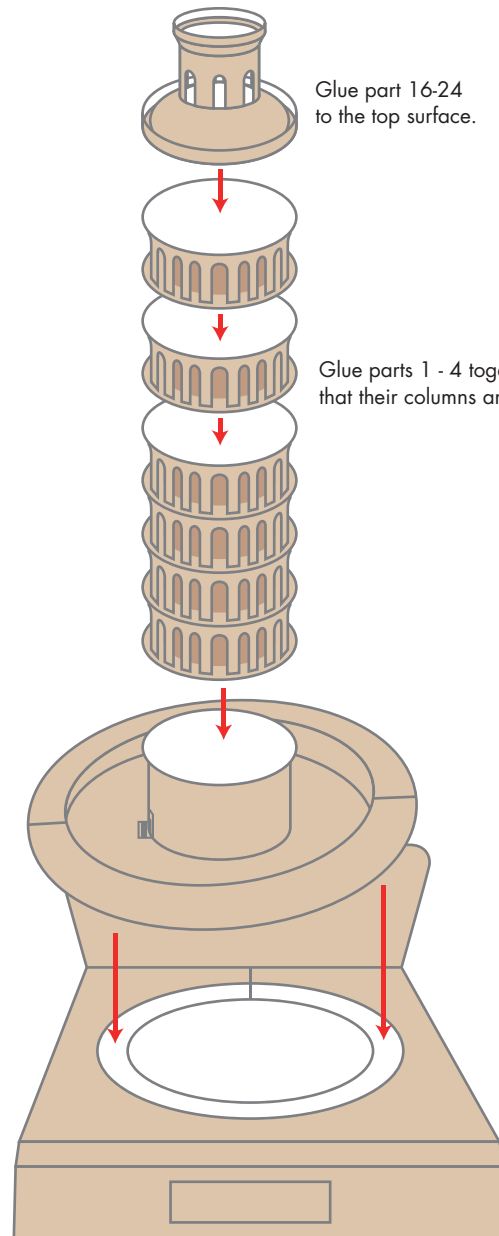
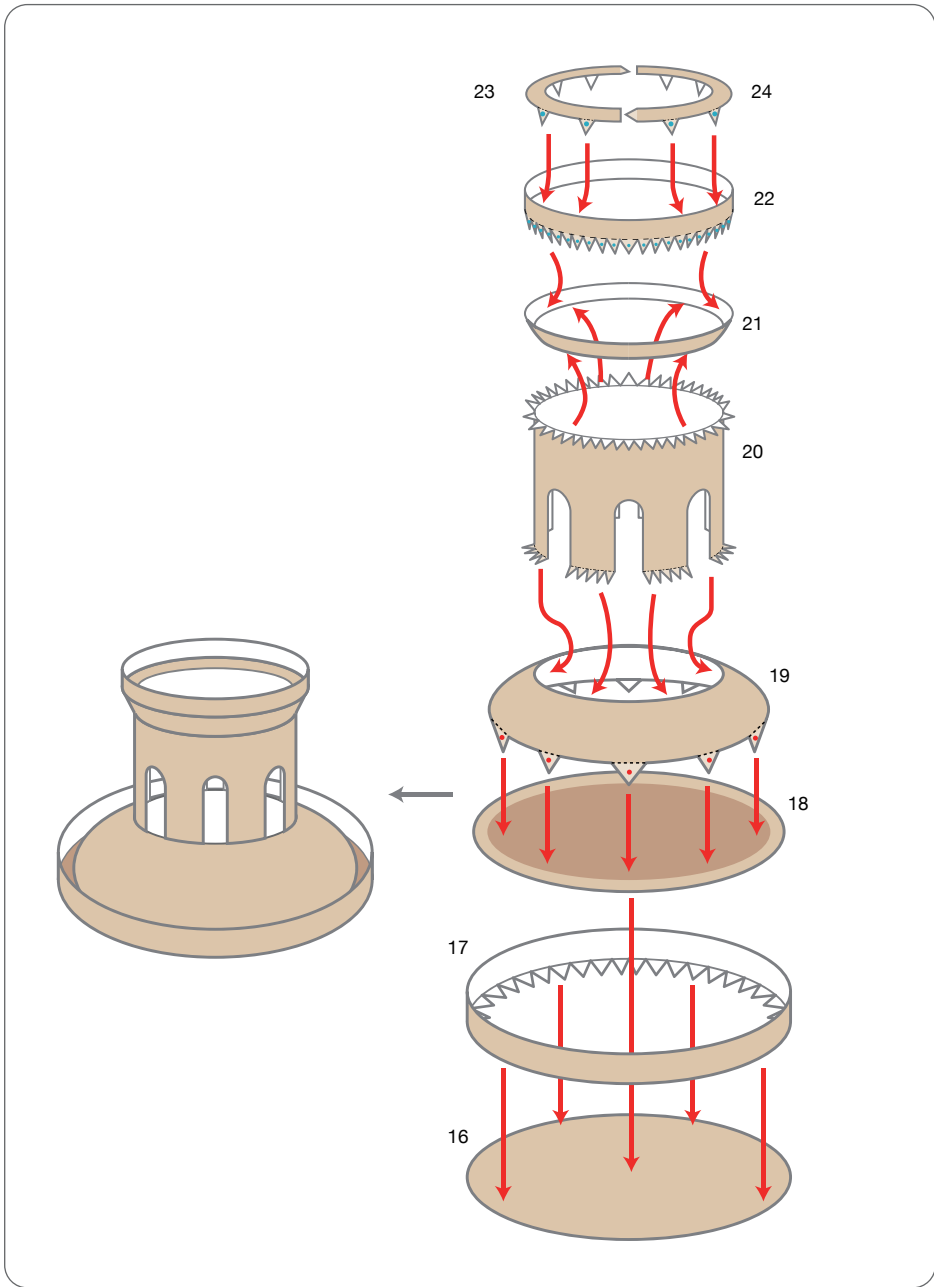

Finished!