



(Moving) Circus strongman : Assembly Instructions

© Canon Inc. © Hideharu Naitoh & unity design



PAPER CRAFT

<http://www.canon.com/c-park/en/>



* The circus strongman puts on an entertaining performance, raising and lowering his arms when you move the lever beneath the frame up and down.

View of completed model

Assembly Instructions : Five A4 sheets (No. 1 to No. 5)

* Build the model by carefully reading the Assembly Instructions , in the parts sheet page order.

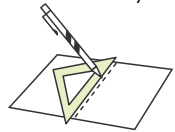

*Hint: Trace along the folds with a ruler and an exhausted pen (no ink) to get a sharper, easier fold.

Assembly Instructions



Mountain fold(dotted line)
Make a mountain fold.



Valley fold(dashed and dotted line)
Make a valley fold.



Scissors line(solid line)
Cut along the line.



Cut in line(solid line)
Cut along the line.



Glue
The glue spot(colored dot) shows where to apply the glue.



Glue spot(Red dot)
Glue parts with the same number together.



Glue spot(Green dot)
Glue within the same part.



Glue spot(Blue dot)
Glue to the rear of the other part.

Tools and materials



Scissors, set square, glue(We recommend stick glue), pencil, used ballpoint pen, toothpicks, tweezers, (useful for handling small parts)

Assembly tip



Before gluing, create the paper along mountain fold and valley fold lines and make sure rounded sections are nice and stiff.

Caution



Glue, scissors and other tools may be dangerous to young children so be sure to keep them out of the reach of young children.

Before starting assembly : Writing the number of each section on its back side before cutting out the sections is highly recommended.
(* This way, you can be sure which section is which even after cutting out the sections.)

→ Indicates where sections should be glued together.
→ Indicates where to insert sections. Do not glue the sections together.

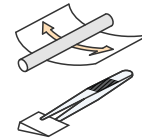

Round bar : Use to give parts a curved surface.

Tweezers : Useful in working with fine parts.



Be sure to build this model carefully.



Glue the entire reverse sides of part 1 and part 4 to each other, as shown in this illustration. Take care in positioning and direction of the parts when gluing them.

Caution : Spread the glue in a thin layer, to prevent these parts from warping after you glue them together.

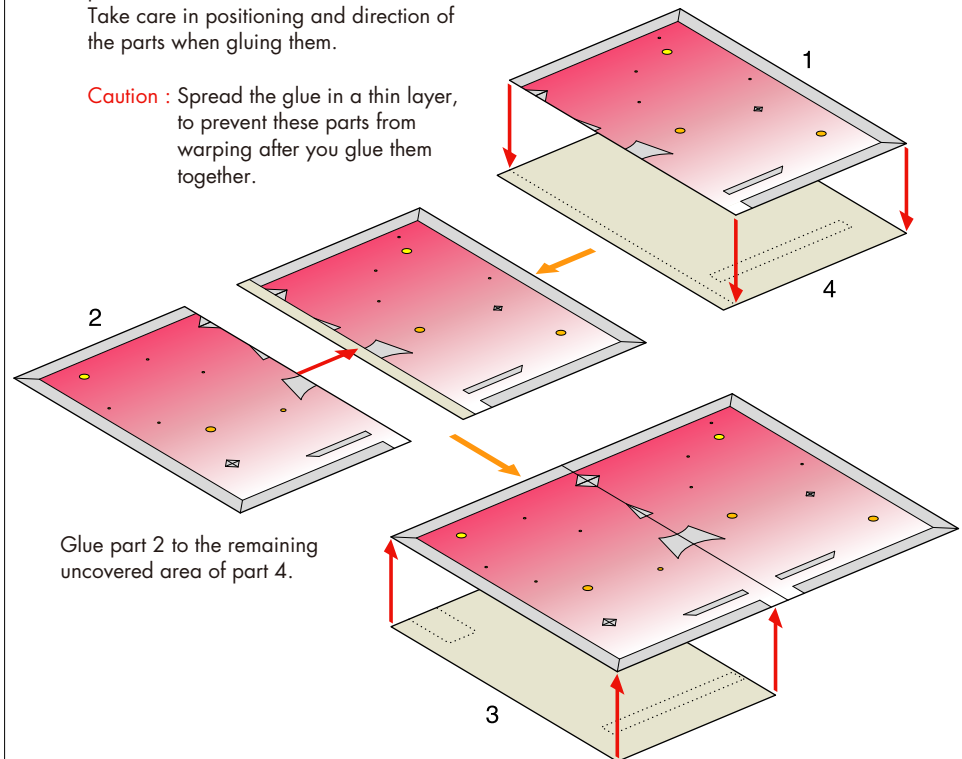

Glue part 2 to the remaining uncovered area of part 4.

Glue the rear sides of part 2 and part 3 to each other, lining these parts up.



(Moving) Circus strongman : Assembly Instructions

© Canon Inc. © Hideharu Naitoh & unity design

Canon

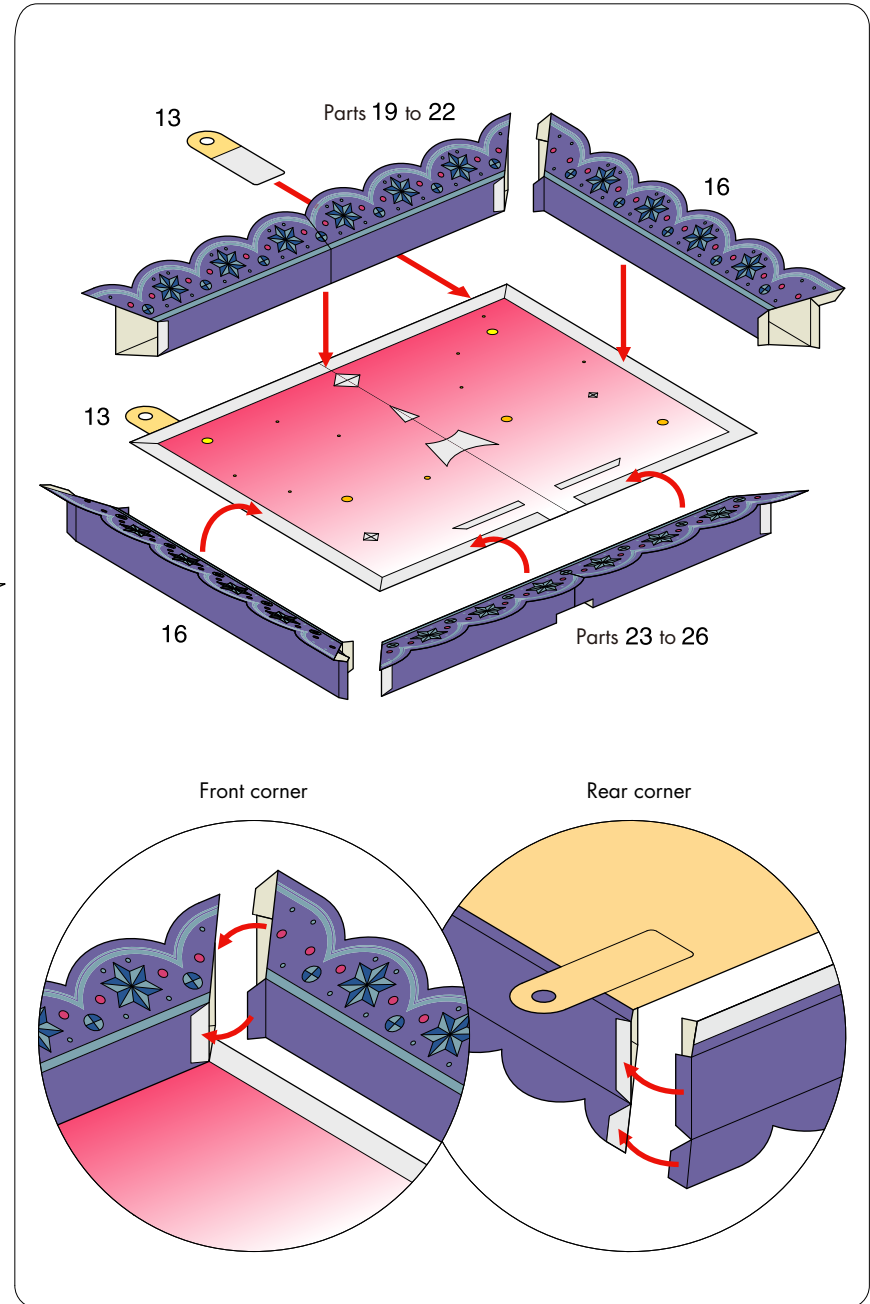
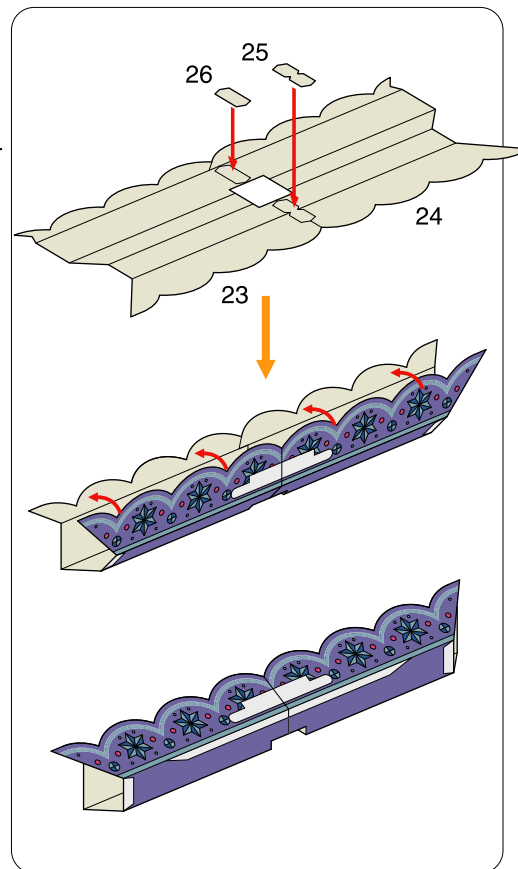
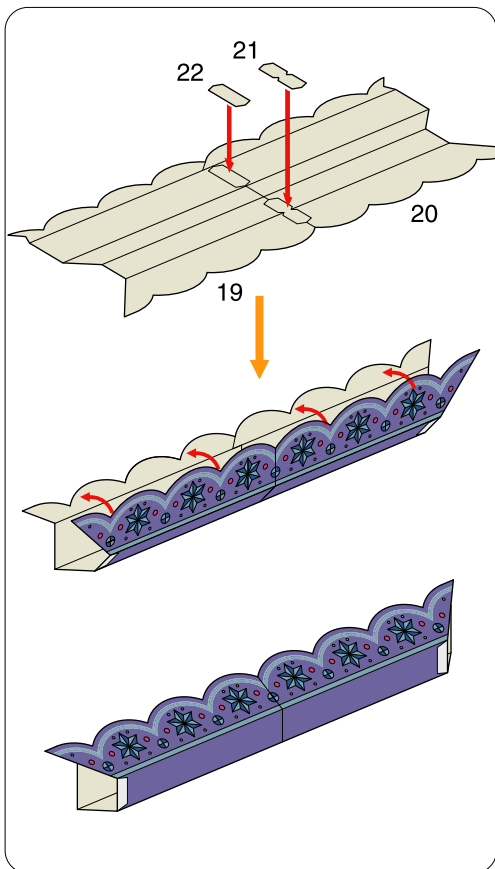
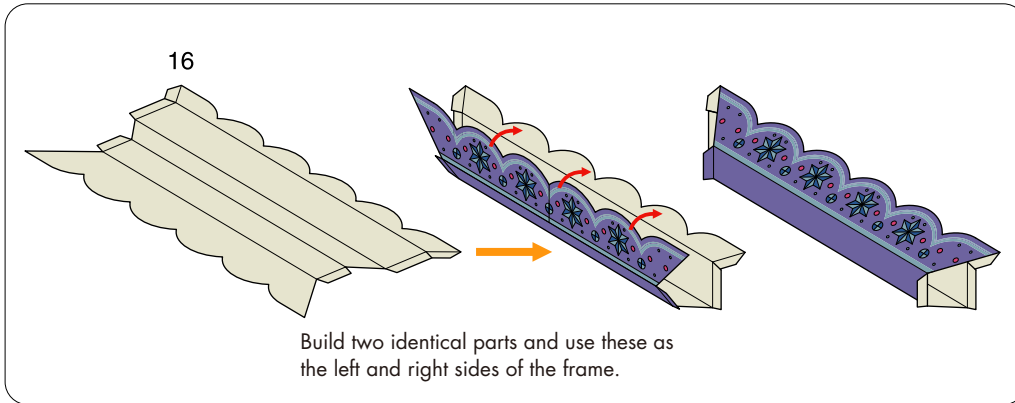



(Moving) Circus strongman : Assembly Instructions

30 Glue part 29 together in the same way.

31

32

28

29

Parts 32 and 33

33

33

33

43

Move the lever up and down to check the movement of the arms.

Parts 1 and 2

17

18

Parts 28 to 33 and 43

Parts 23 to 26

After assembling all the parts, glue the indicated glue spots of part 31 to the glue spots indicated as 1d on background parts 1 and 2.

43

Caution : Avoid gluing the entire area of the surfaces together, since this could cause them to warp.



(Moving) Circus strongman : Assembly Instructions

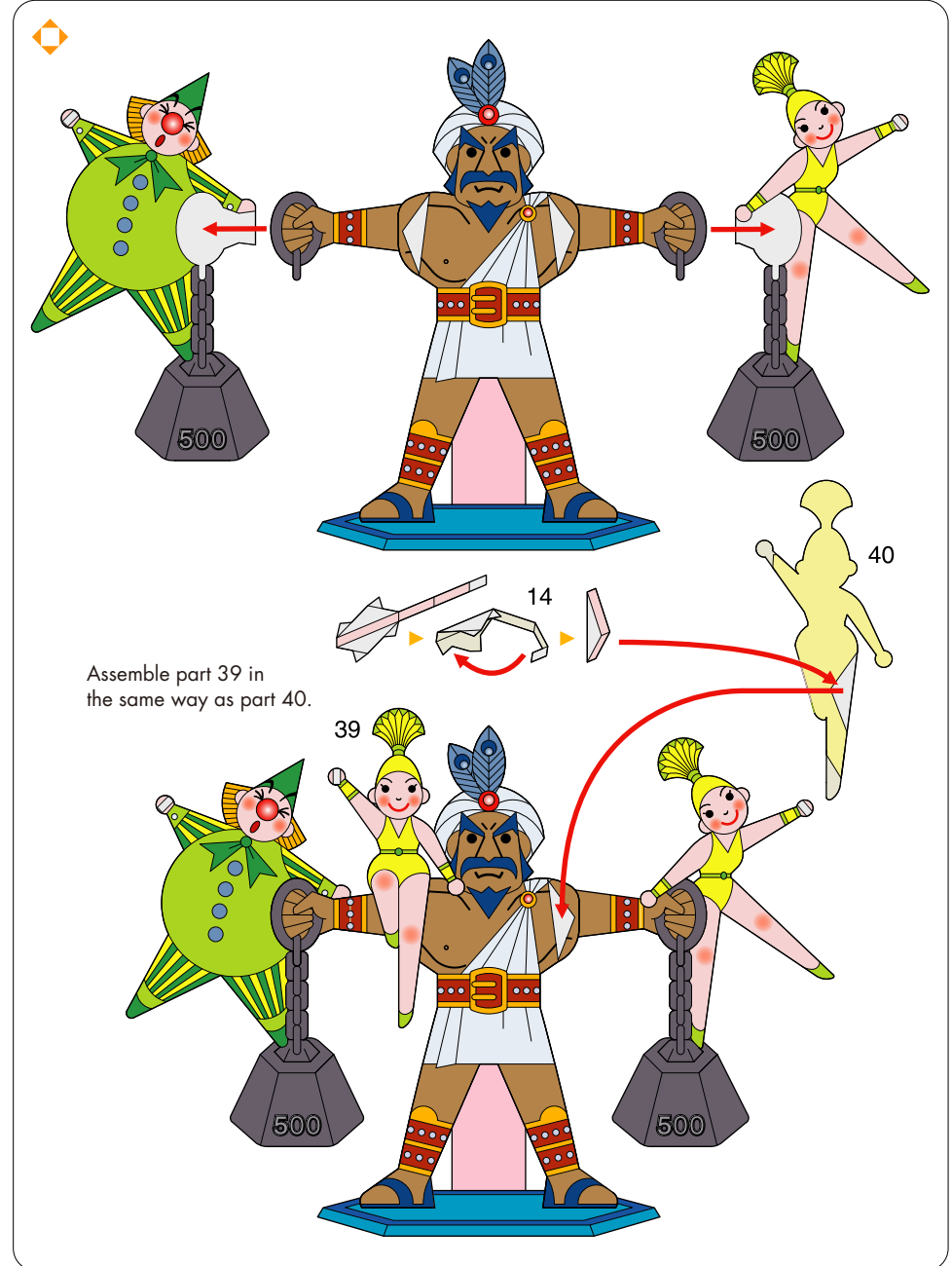
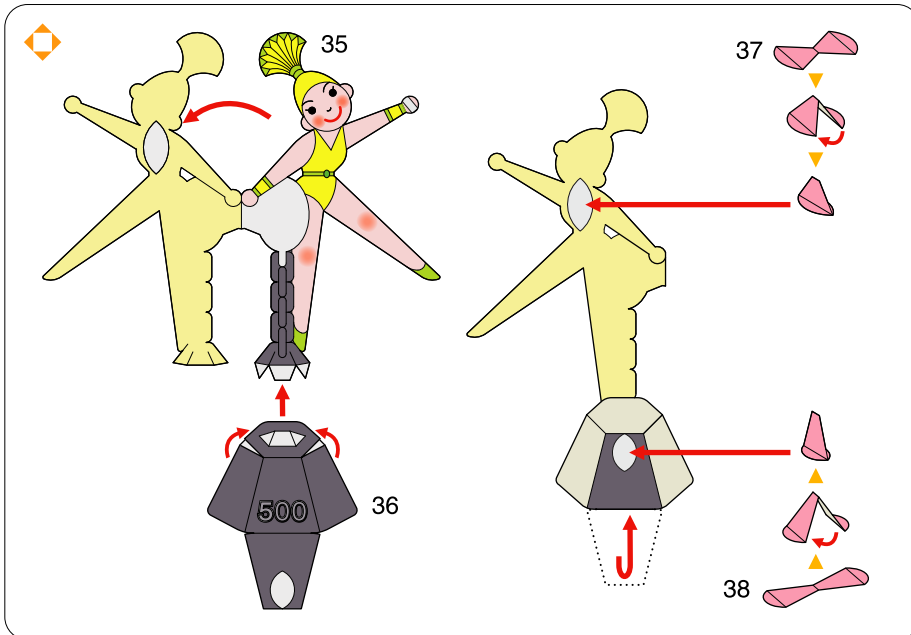
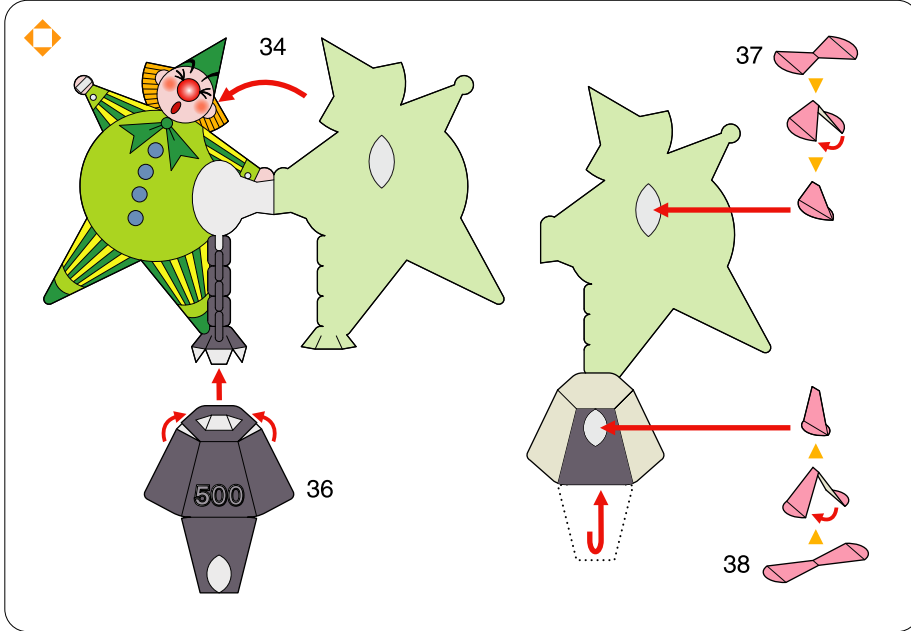



(Moving) Circus strongman : Assembly Instructions

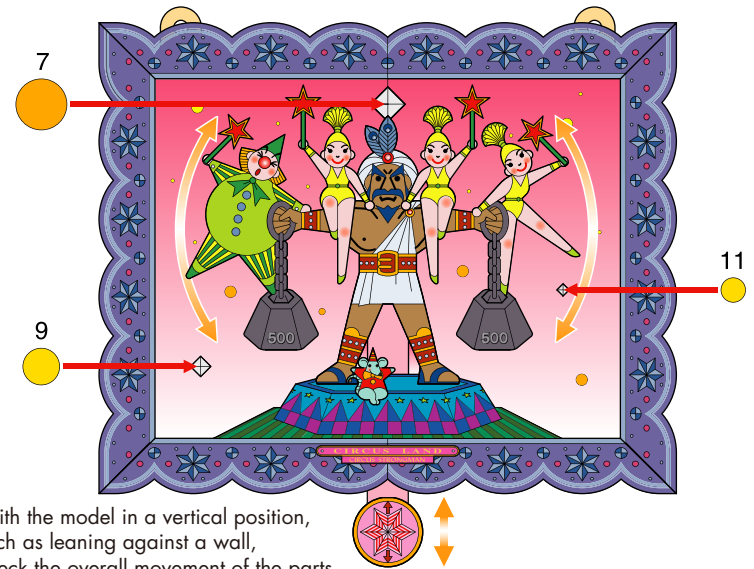
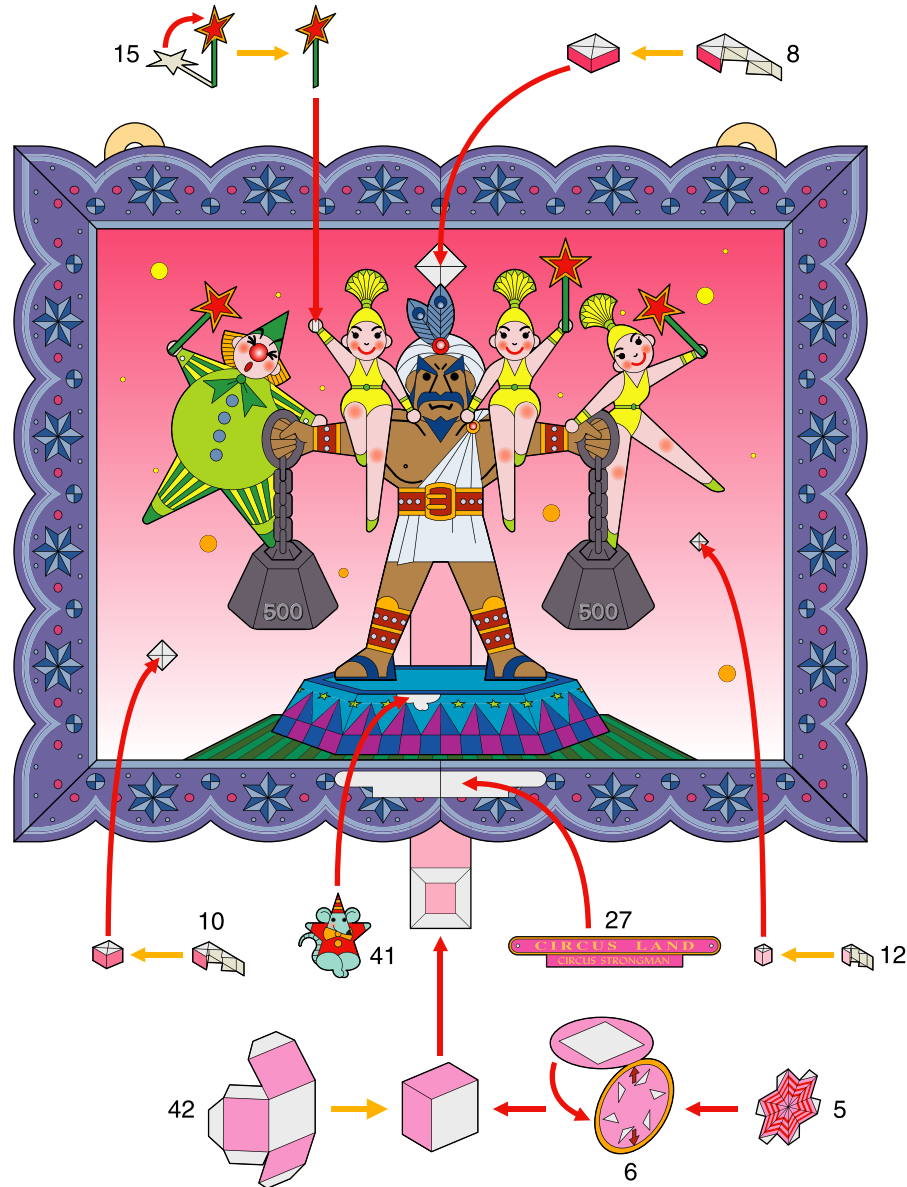

With the model in a vertical position, such as leaning against a wall, check the overall movement of the parts.

Finished!

